



TECHNICAL INFORMATION



TABLE OF CONTENTS

STUDIOS AT A GLANCE	3
STUDIO 80	4
RIGGING	6
POWER	7
ROOMS	8
CATERING	10

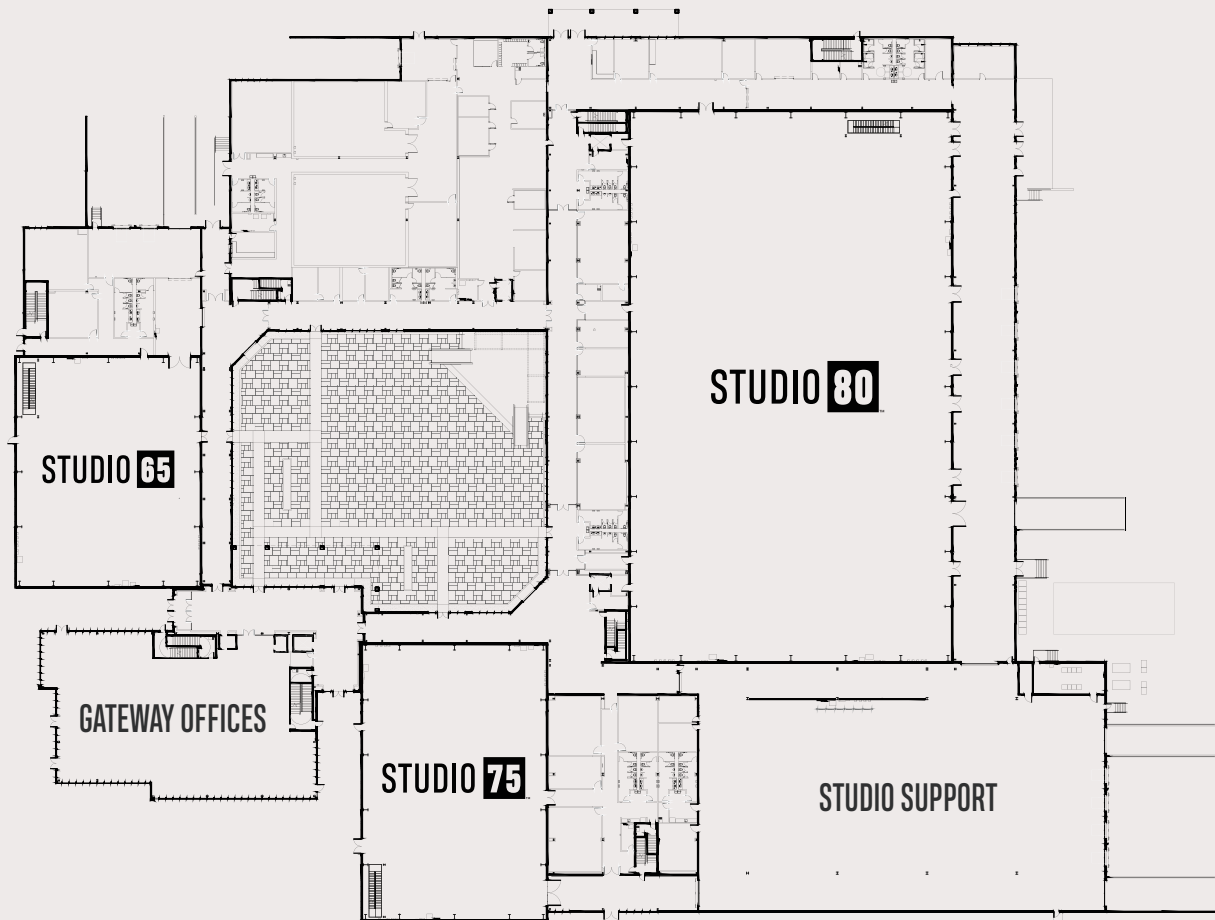

AT A GLANCE

- 3 Multi-purpose Studio Facilities with dedicated loading docks, dressing rooms, offices, and catering lounges
- 80,000 ft² of total studio space
- 25,000 ft² outdoor courtyard
- 15,700 ft² of additional support space
- Full service, on-site catering available
- On-site laundry facilities
- 3 Previsualization Suites
- All studios acoustically treated

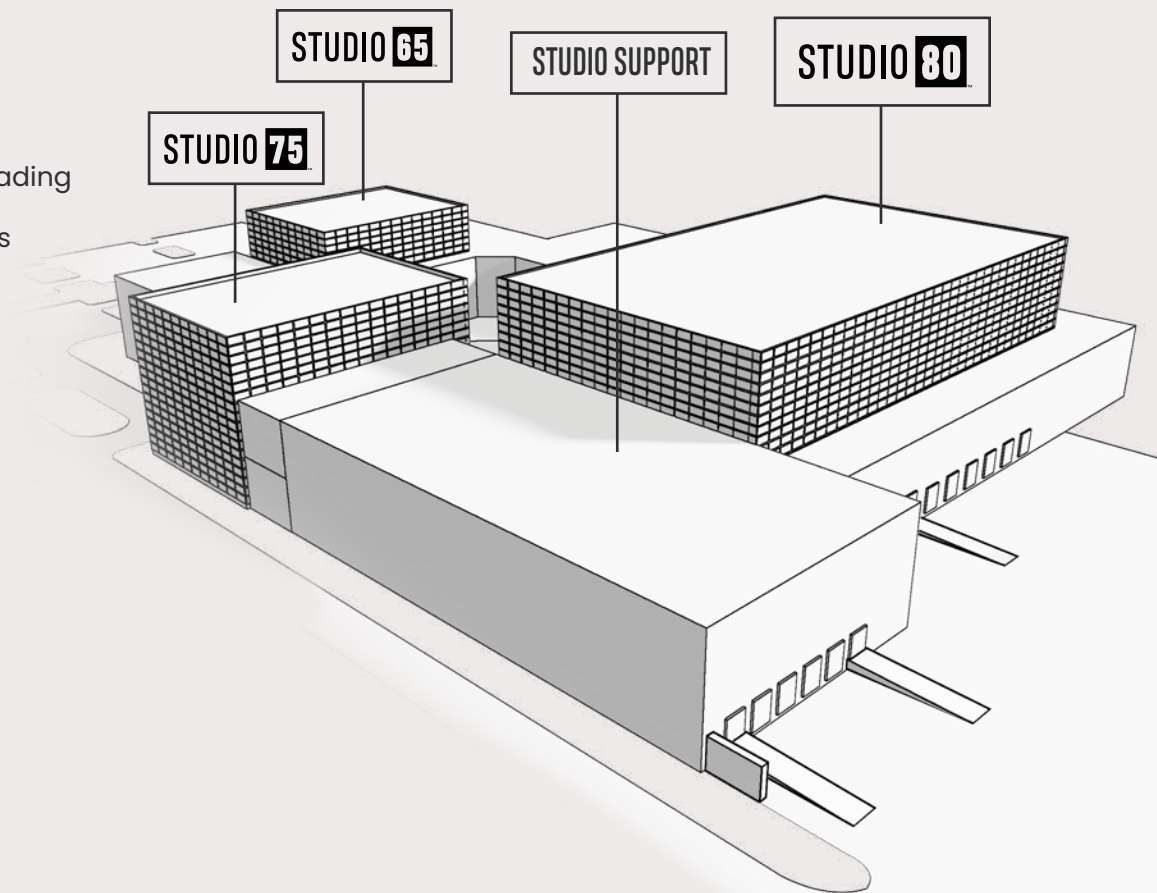





- 300' x 175' Wall-to-Wall
- 294' x 169' beam-to-beam
- 52,500 ft²
- 80 Foot Grid Height with 10' x 10' Bays
- 2,000,000 pounds Grid Weight Capacity
- Floor Etched to Reflect Rigging Grid
- 10 – 400 Amp, Three Phase Services
- 8 – 200 Amp, Three Phase Services
- Elevator access to second floor
- 10,800 ft² receiving / staging
- 15,000 ft² additional offices / rooms
- Every room includes:
 - Power
 - WI-FI
 - Access Control
- Hardwire data available on request

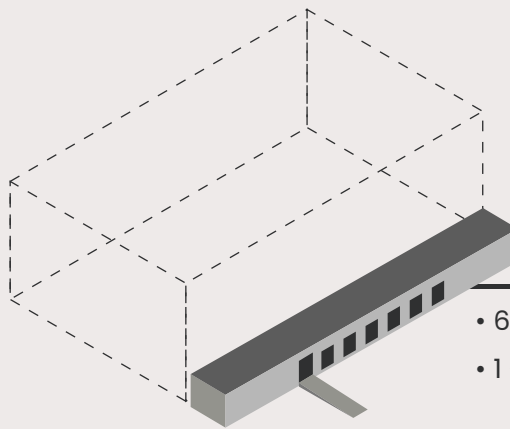

10,800 FT² OF DEDICATED RECEIVING/STAGING

- 6 – Loading Dock bays with levelers and truck power
- 1 – Drive-In Ramp 14' x 12'

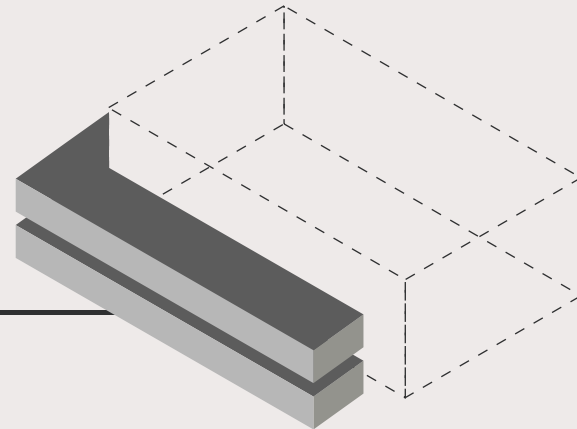

15,000 FT² OF DEDICATED DRESSING ROOMS, OFFICES & CATERING

- 13 – Offices / Dressing Rooms
- 5,396 ft² Catering Lounge, seating for 150+
- 1,776 ft² Kitchen Commissary



RIGGING SPECIFICATIONS

- 80 Foot Grid Height with 10' x 10' Bays
- 200,000 lbs. between each truss
- Two Endwalls at 100,000 lbs each
- 30,000 lbs. on W24 along length of beam
- 10,000 lbs. on W12*

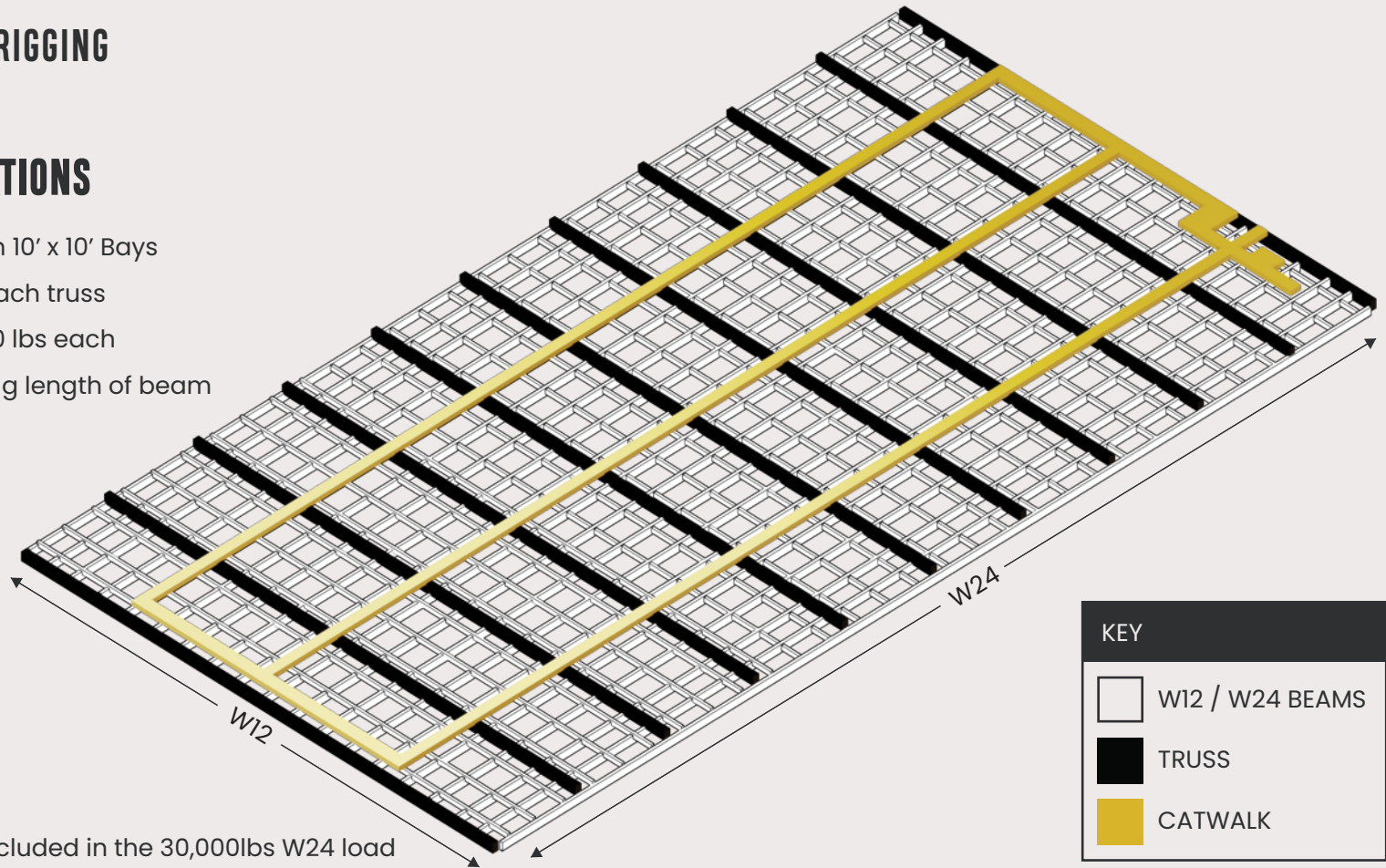

*Loads on the W12 are included in the 30,000lbs W24 load



STUDIO 80 POWER

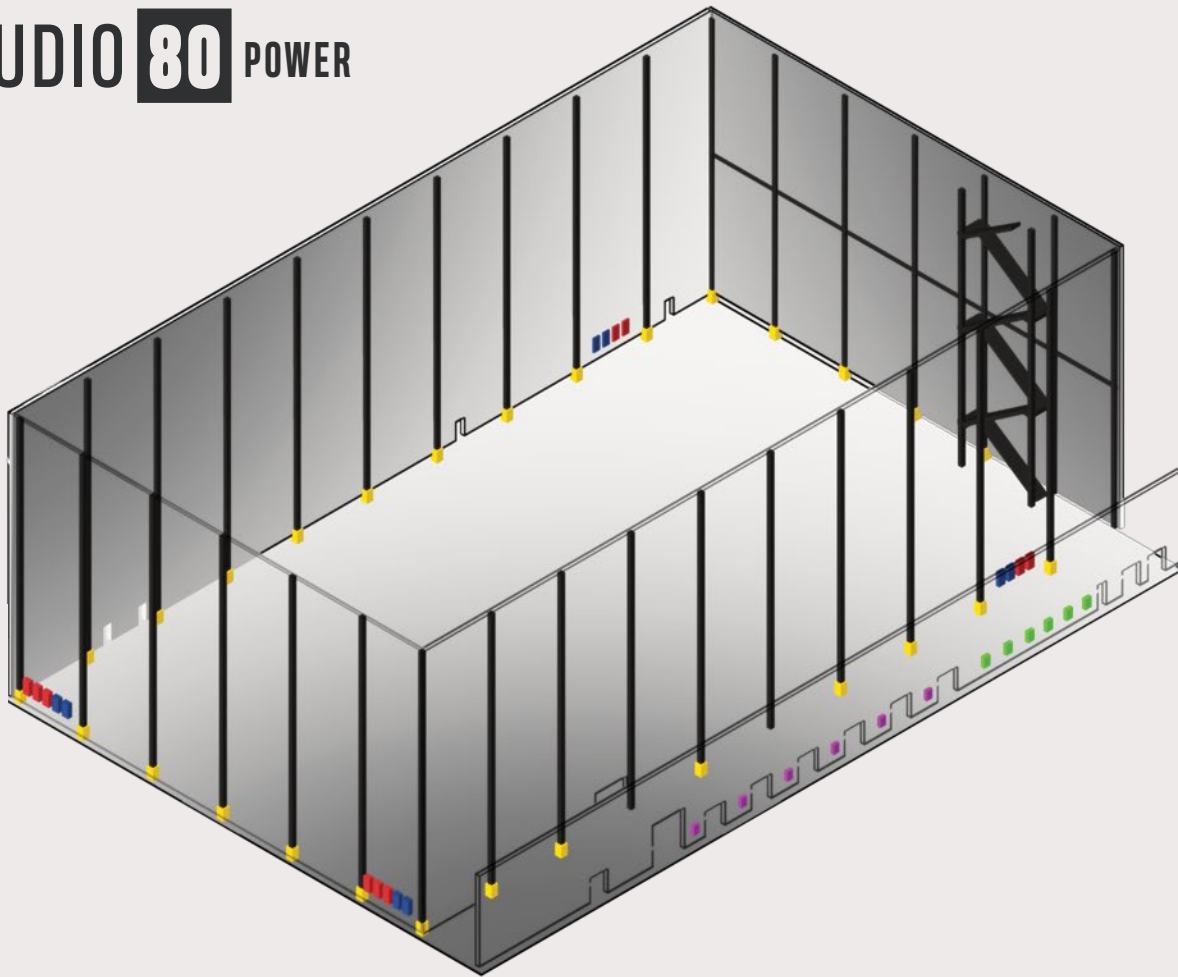

KEY

- 200 amp, Three Phase Service (8)
- 400 amp, Three Phase Service (10)
- 20 amp Quad Box & Data Port (28)
- 20 amp + 50 amp - Bus Power (6)
- 20 amp - Truck Power (6)



STUDIO 80 FIRST FLOOR ROOMS

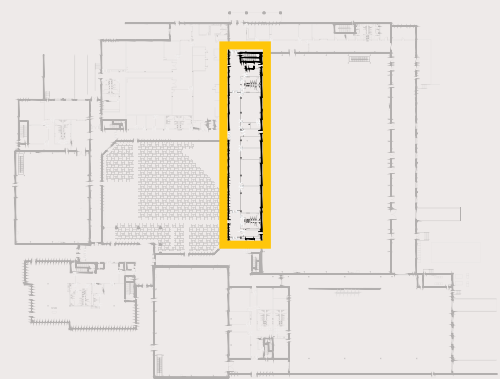
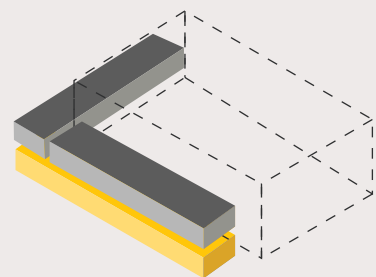



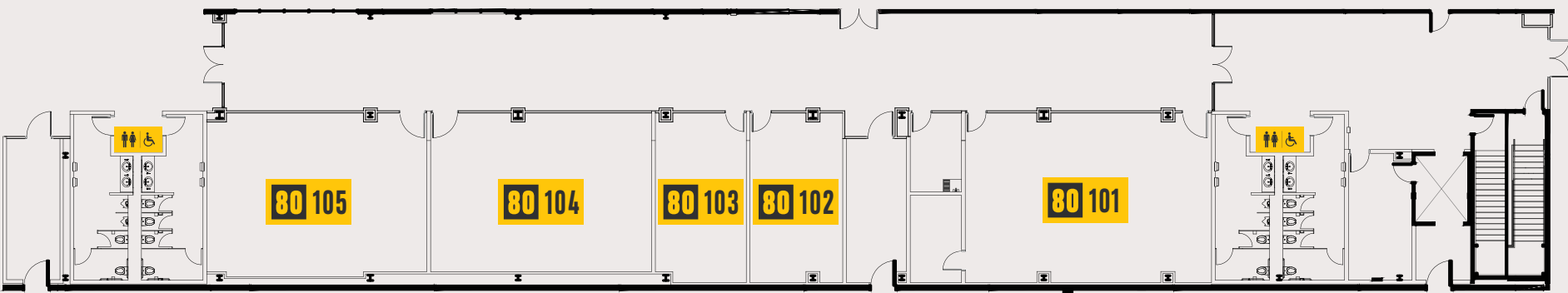



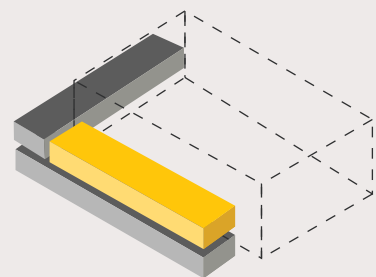











- 80 101** 39' x 27' 1,053 ft²
- 80 102** 14' x 27' 378 ft²
- 80 103** 14' x 27' 378 ft²
- 80 104** 35' x 25' 875 ft²
- 80 105** 35' x 25' 875 ft²



STUDIO 80 SECOND FLOOR ROOMS



80 201	26' x 16' 416 ft²	80 205	22' x 26' 572 ft²	  	
80 202	22' x 26' 572 ft²	  	80 206	22' x 26' 572 ft²	  
80 203	22' x 26' 572 ft²	  	80 207	22' x 26' 572 ft²	  
80 204	22' x 26' 572 ft²	  	80 208	16' x 19' 304 ft²	

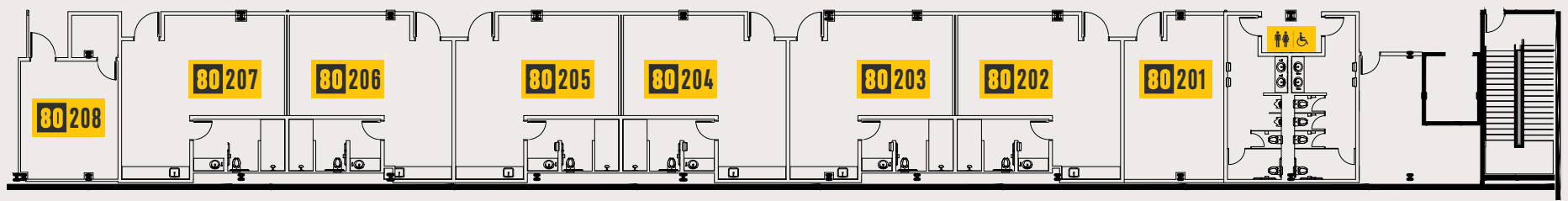

STUDIO 80 CATERING LOUNGE

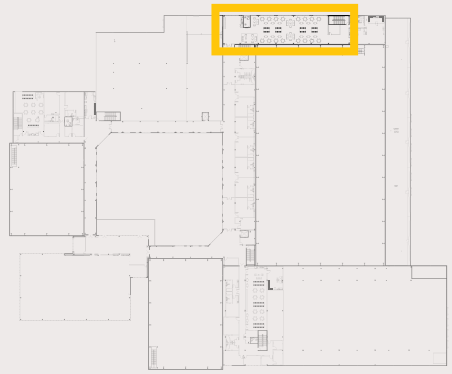
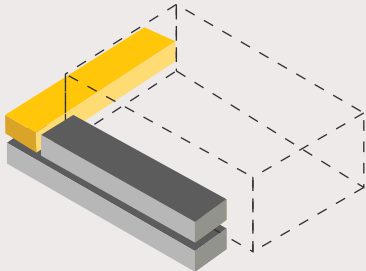

80 CATERING 5,396 ft²

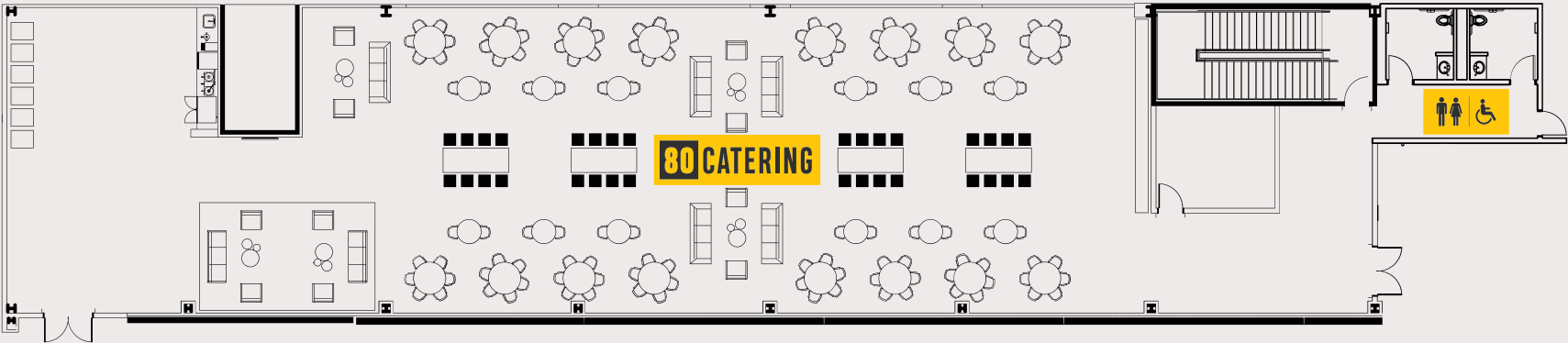

ADDRESS

Gateway Studios

900 Spirit of Saint Louis Blvd
Chesterfield, MO 63005

CONTACT

For studio inquiries and questions:
studios@gsps.com

