

GATEWAY[™]
S T U D I O S

STUDIO **75**[™]

TECHNICAL INFORMATION



GATEWAY STUDIOS

TABLE OF CONTENTS

| | |
|---------------------------|----|
| STUDIOS AT A GLANCE | 3 |
| STUDIO 75 | 4 |
| RIGGING | 6 |
| POWER | 7 |
| ROOMS | 8 |
| DOCKS | 10 |

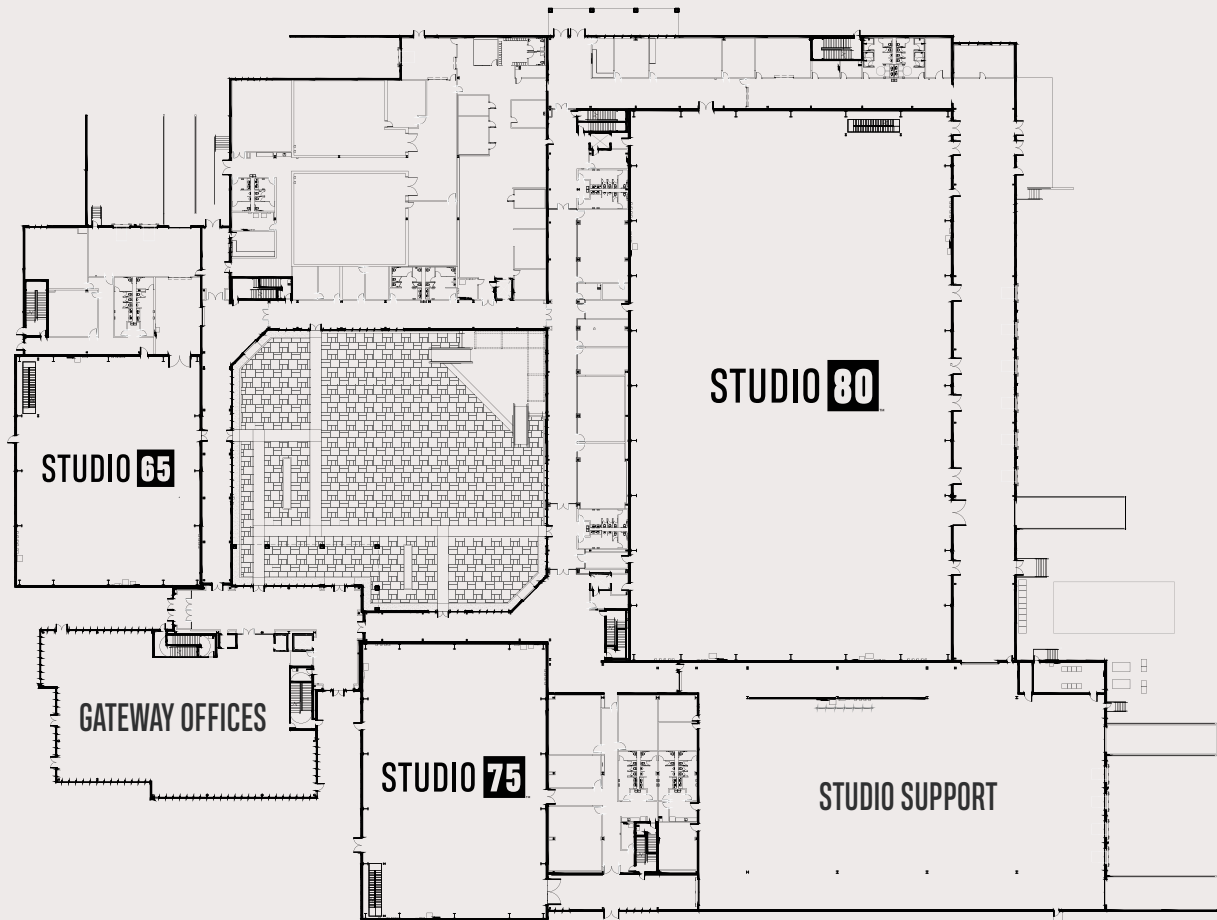

AT A GLANCE

- 3 Multi-purpose Studio Facilities with dedicated loading docks, dressing rooms, offices, and catering lounges
- 80,000 ft² of total studio space
- 25,000 ft² outdoor courtyard
- 15,700 ft² of additional support space
- Full service, on-site catering available
- On-site laundry facilities
- 3 Previsualization Suites
- All studios acoustically treated

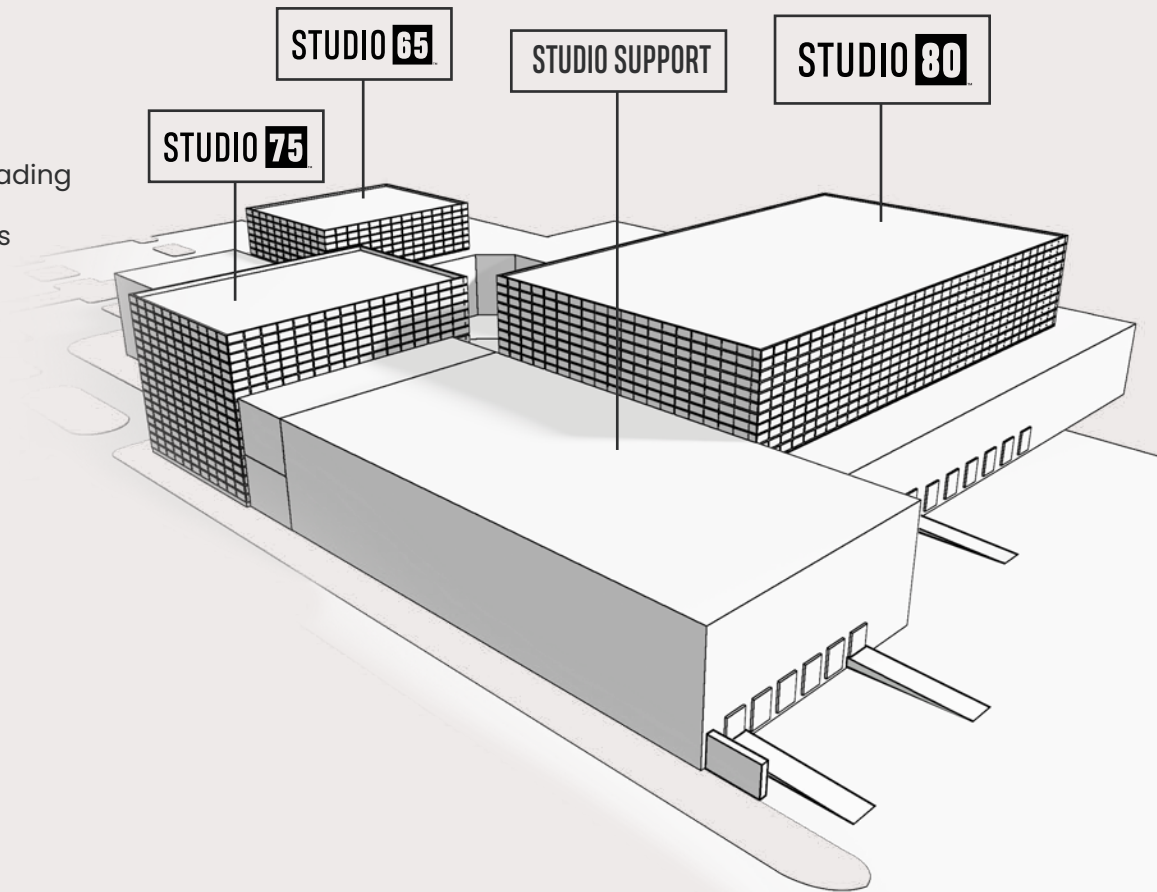

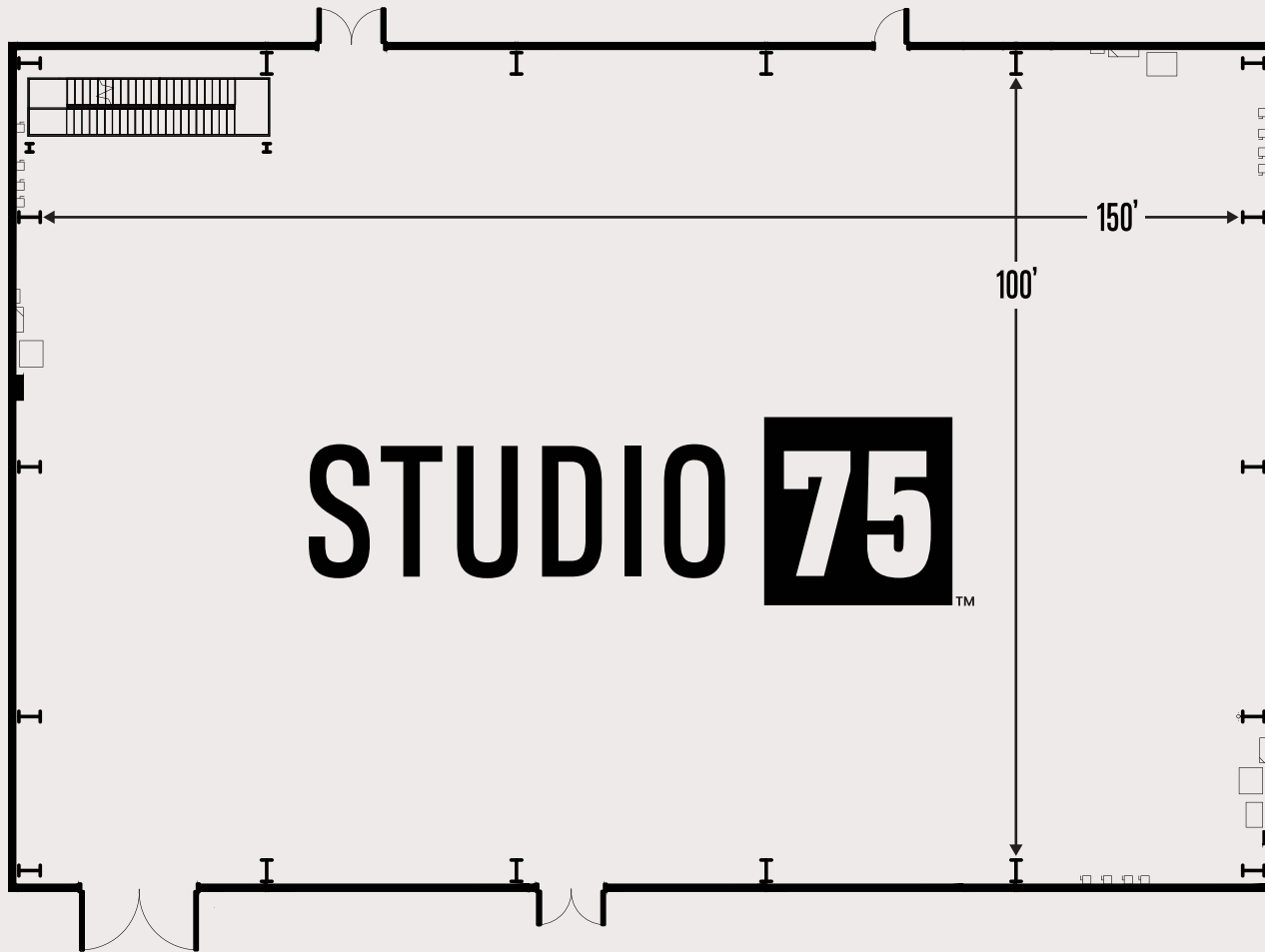

STUDIO 75™

- 150' x 100' wall to wall
- 15,000 ft²
- 75 Foot Grid Height with 10' x 6' Bays
- 1,000,000 pounds Grid Weight Capacity
- Floor Etched to Reflect Rigging Grid
- 6 – 400 Amp, Three Phase Services
- 6 – 200 Amp, Three Phase Services
- Elevator access to second floor
- 4,000 ft² of receiving / staging
- 8,000 ft² of additional offices / rooms
- Laundry Room with 2 sets of washers and dryers
- Every room includes:
 - Power
 - WI-FI
 - Access Control
- Hardwire data available on request

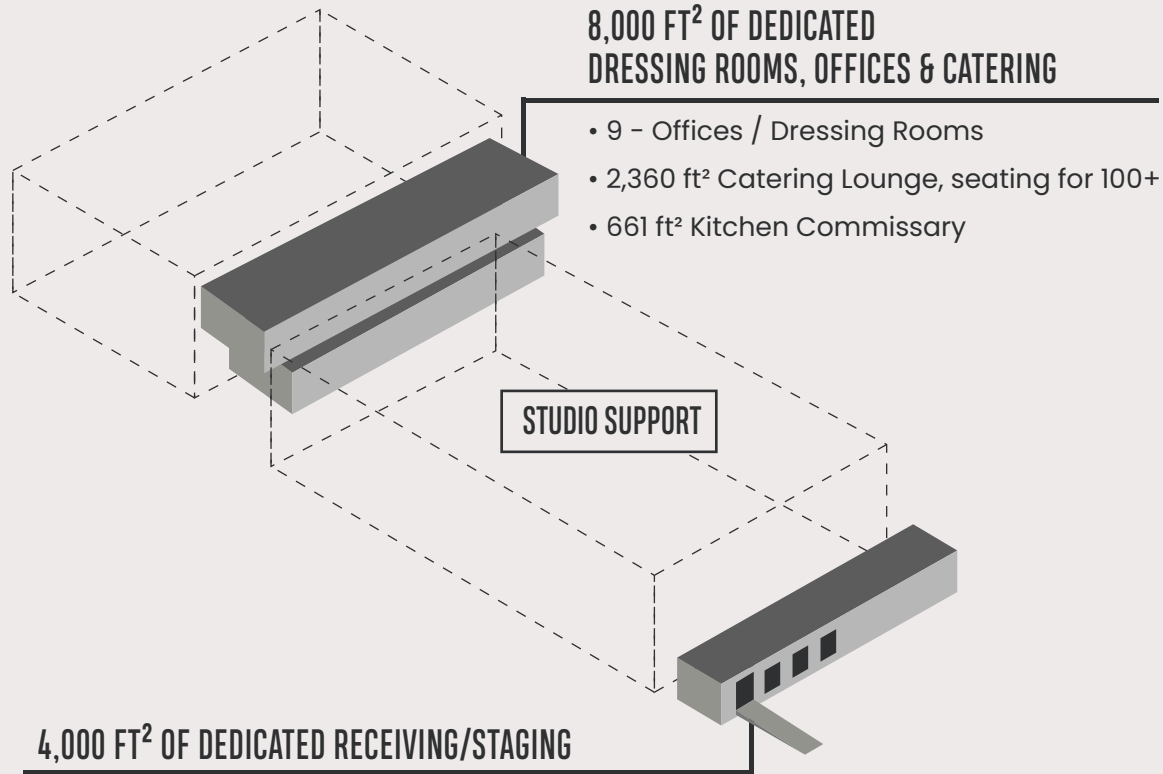

- 3 – Loading Dock bays with levelers and truck power
- 1 – Drive-In Ramp 14' x 12'



RIGGING SPECIFICATIONS

- 75 Foot Grid Height with 10' x 6' Bays
- 200,000 lbs. between each truss
- Two Endwalls at 100,000 lbs each
- 30,000 lbs. on W24 along length of beam
- 10,000 lbs. on W12*

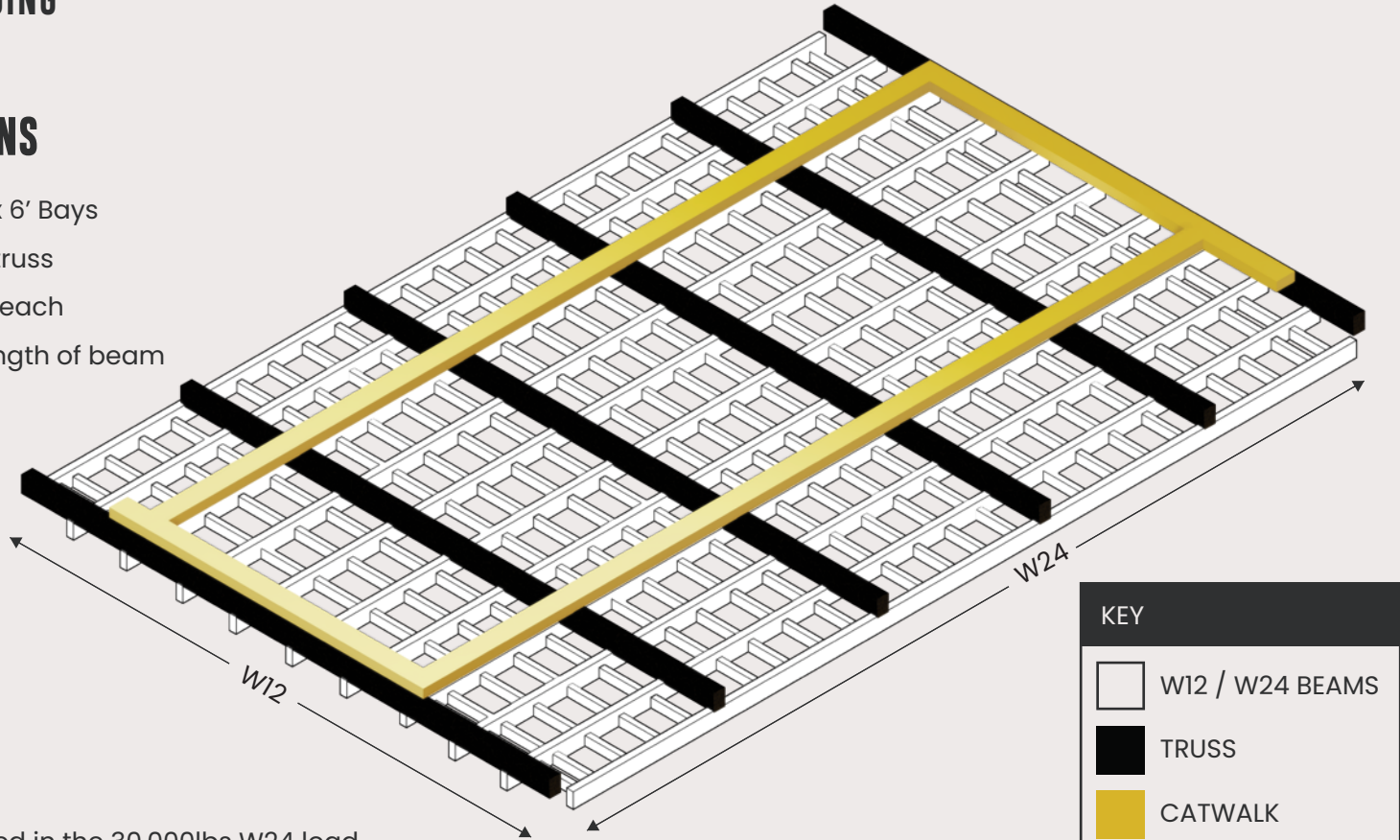

*Loads on the W12 are included in the 30,000lbs W24 load



STUDIO 75 POWER

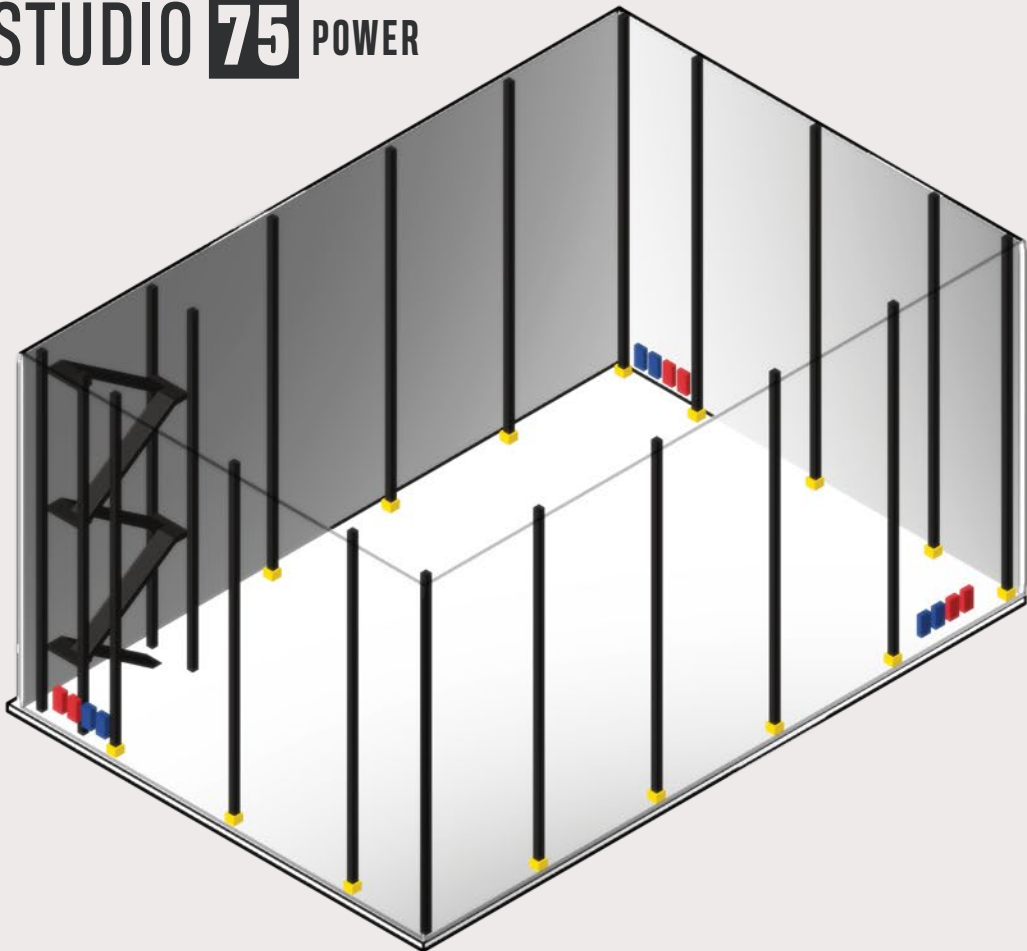

KEY

- 200 amp, Three Phase Service (6)
- 400 amp, Three Phase Service (6)
- 20 amp Quad Box & Data Port (15)
- 20 amp - Truck Power (3)

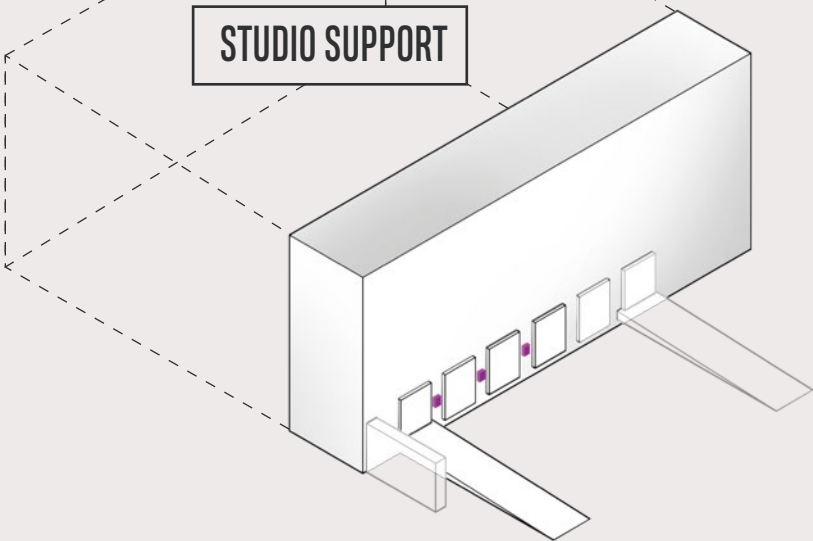

STUDIO 75 FIRST FLOOR ROOMS

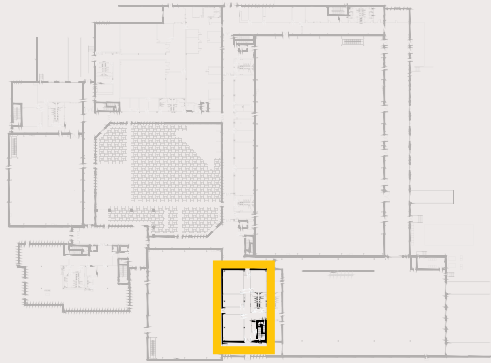
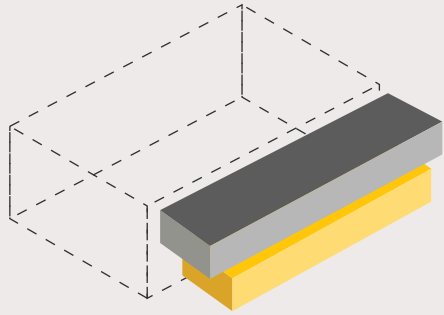

| | | |
|---------------------|-----------------|---------------------|
| PRODUCTION 1 | 28' x 32' | 896 ft ² |
| PRODUCTION 2 | 21' x 30' | 630 ft ² |
| PRODUCTION 3 | 28' x 17' | 476 ft ² |
| PRODUCTION 4 | 28' x 35' | 980 ft ² |

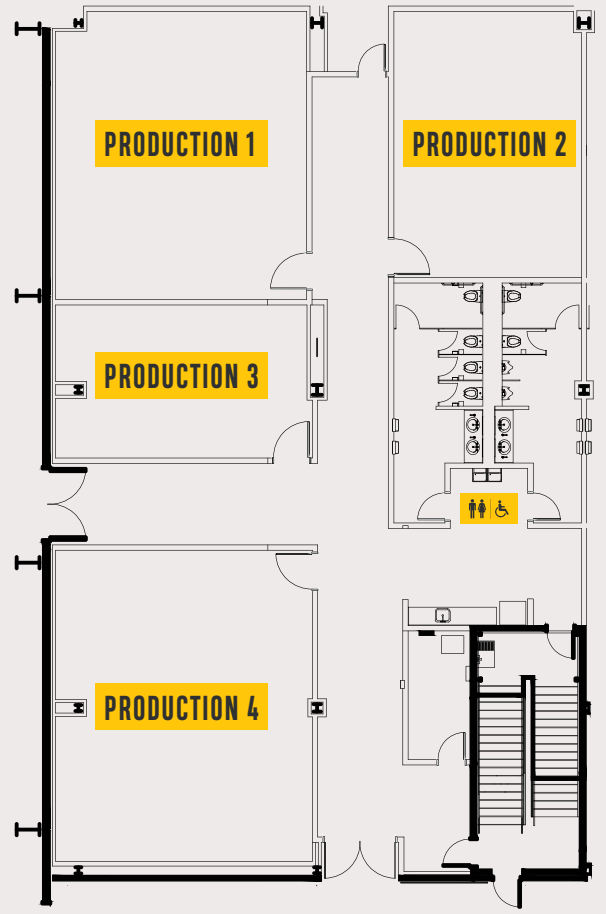

STUDIO 75 SECOND FLOOR ROOMS

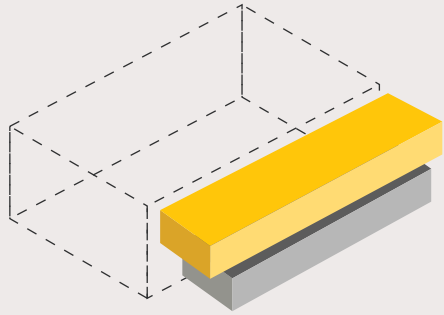

| | | | |
|------------------------|-----------------------------|---------------------|-------|
| DRESSING ROOM 1 | 20' x 28' | 560 ft ² | ♂ ♀ ♿ |
| DRESSING ROOM 2 | 17' x 18' | 306 ft ² | ♂ ♀ ♿ |
| PRODUCTION 5 | 20' x 23' | 460 ft ² | |
| PRODUCTION 6 | 20' x 19' | 380 ft ² | |
| PRODUCTION 7 | 22' x 12' | 264 ft ² | |
| CATERING | 2,352 ft ² | | |
| LAUNDRY | | | |

*Additional "space" available upon request

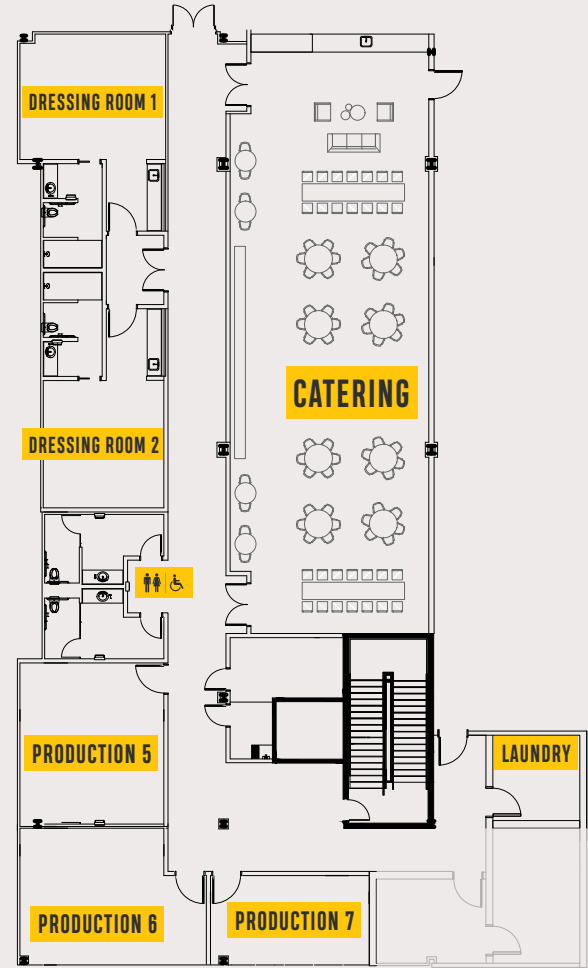

STUDIO 75 DOCKS

The Studio 75 docks are located on the east side of our Studio Support space. Trucks can use the drive-up ramp (Door 1) to drive directly into Studio 75 as well as utilize the three additional docks (Doors 2, 3, & 4).

Doors 5 & 6 are reserved for Studio Support.

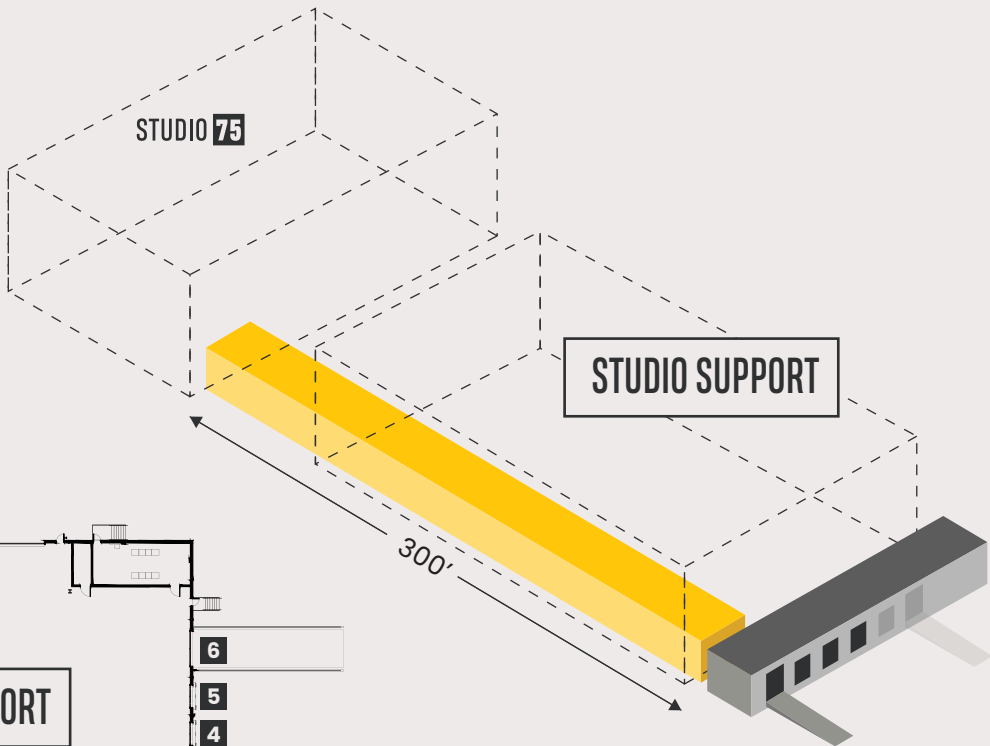
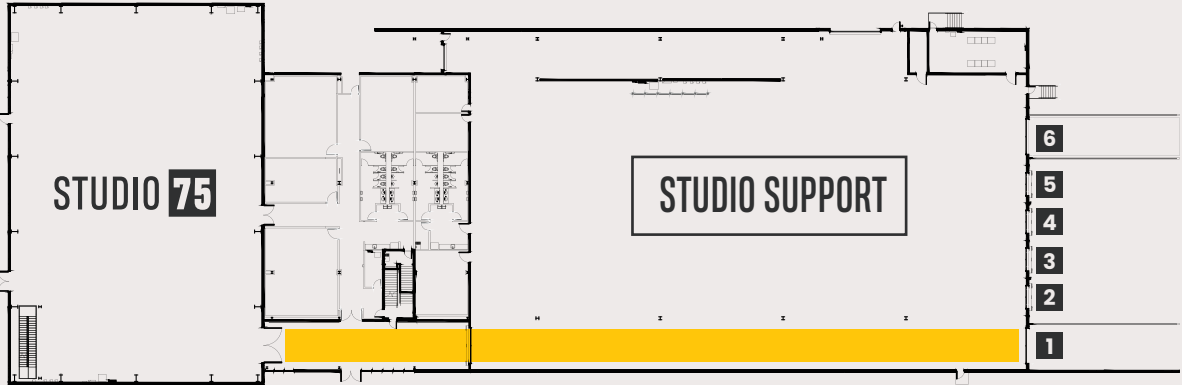

STUDIO 75 DOCKS & OVERFLOW PARKING

Eastbound on I-64 - Chesterfield Airport Road Exit 14

- Continue on Chesterfield Airport Road
- Turn left on Spirit Commerce Drive to access studio loading docks

Westbound on I-64 - Long Road Exit 16

- Turn right onto Chesterfield Airport Road
- Turn right on Spirit Commerce Drive to access studio loading docks

Truck Overflow Parking from the Studios

- Exit on the west end of Spirit Commerce Drive
- Turn Right on Spirit of St. Louis Blvd
- Turn Left on N Outer 40 Rd
- Turn Right and continue straight to access the overflow parking lot

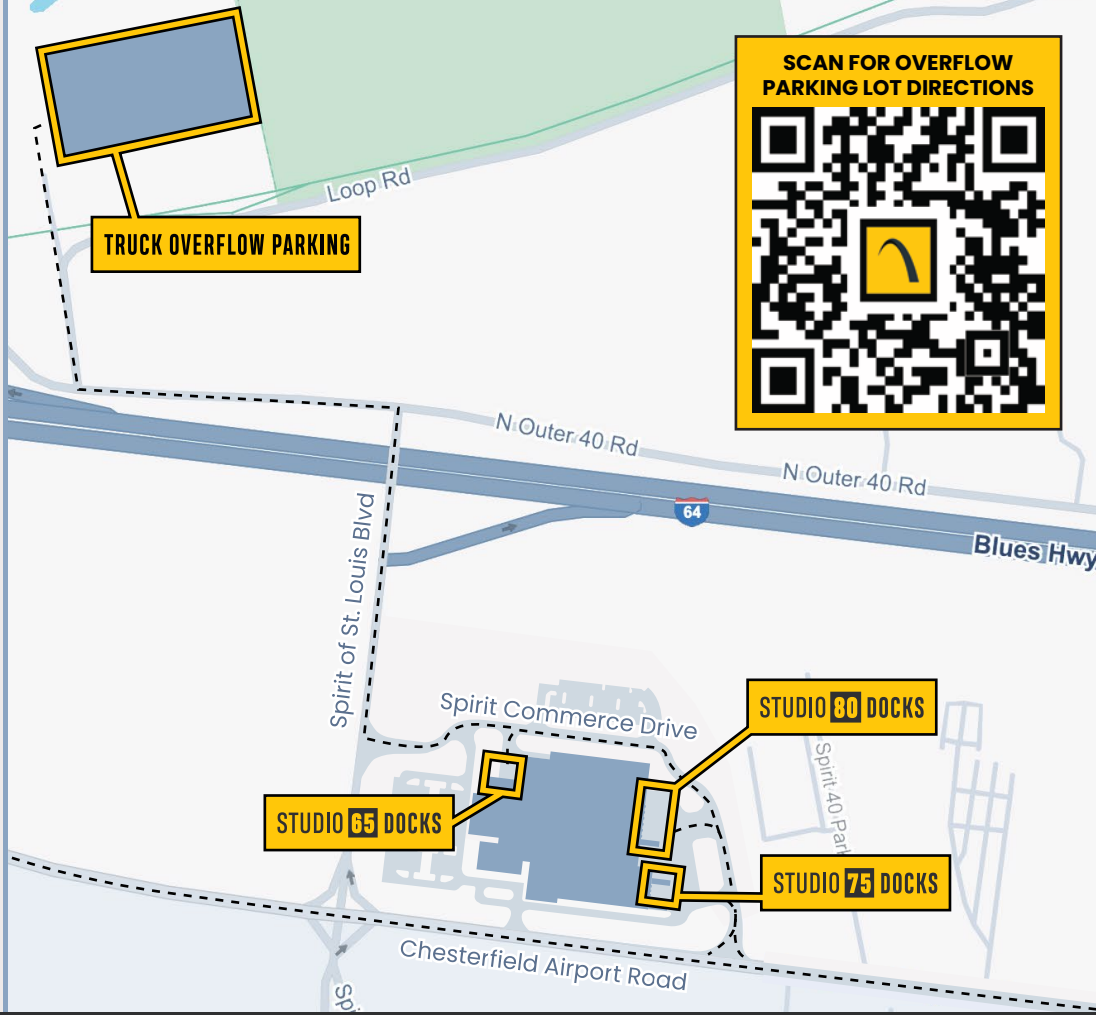

ADDRESS

Gateway Studios

900 Spirit of Saint Louis Blvd
Chesterfield, MO 63005

CONTACT

For studio inquires and questions:
studios@gspss.com

